

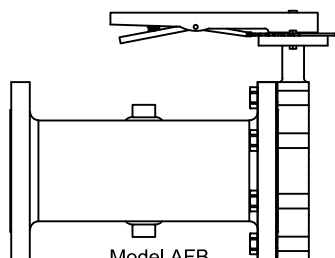

US Industrial Sourcing, L.L.C.

SPECIFICATIONS

Steel Hook-Up Accessory Series



Model AFB
Flange x Butterfly Valve

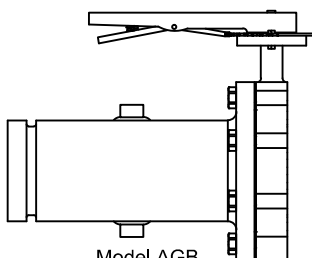

Model AGB
Groove x Butterfly Valve

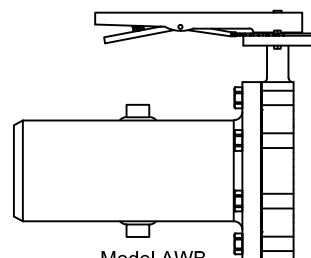

Model AWB
Weld x Butterfly Valve

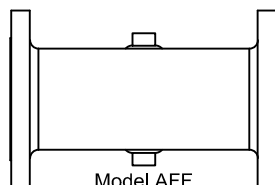

Model AFF
Flange x Flange

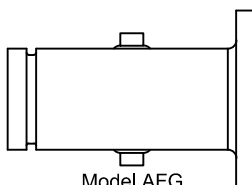

Model AFG
Flange x Groove

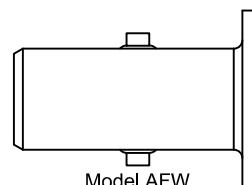

Model AFW
Flange x Weld

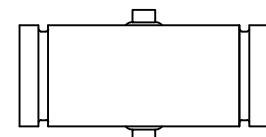

Model AGG
Groove x Groove

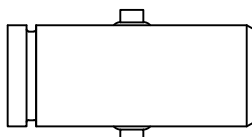

Model AGW
Groove x Weld

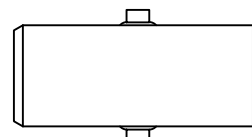

Model AWW
Weld x Weld

BUTTERFLY VALVE END CONNECTION OPTIONS



Slip-On Flange	
Size	Model
2-½"	FL250SO
3"	FL300SO
4"	FL400SO
6"	FL600SO

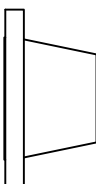

Weld Neck Flange	
Size	Model
2-½"	FL250WN
3"	FL300WN
4"	FL400WN
6"	FL600WN

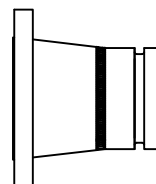

Flange Grooved Adapter	
Size	Model
2-½"	FGA250
3"	FGA300
4"	FGA400
6"	FGA600

PRODUCT DESCRIPTION: The USIS carbon steel hook-up accessory series is available in several end connections, providing a platform for accessory options. Options are installed in 1/2" threaded ports. The two ports are located at the 12:00 and 6:00 positions. Other port locations and port sizes such as 1/4", 3/4", and 1" are available for an additional charge. Optional flange end connections consist of Standard ANSI Class 150 pound raised-face flanges. The optional butterfly valve is rated for dead end service of 150 psi. Custom fabrications and custom lengths are available at an additional charge.

STANDARD MATERIAL SPECIFICATIONS		
Pipe		Steel ANSI Schedule 40
Flange		Forged Carbon Steel ASTM A105
Grooved Adapter		Steel ANSI Schedule 40
Port		Malleable Iron, ASTM A153
Butterfly Valve Components	Body	Nodular Cast Iron ASTM A536 60-4-18
	Seat	EPDM Rubber
	Disc (2½ - 8")	Aluminum-Bronze Sand Casting, ASTM B148 C95800
	Disc (10 & 12")	Nickel Plated Aluminum-Bronze Sand Casting, ASTM B148 C95800
	Shaft	Stainless Steel AISI 410
	O-Ring	EPDM Rubber
	Bearing	Copper ASTM B45
	Bearing Bush	PTFE
	Hand Lever	Nodular Cast Iron ASTM A536 60-4-18



US Industrial Sourcing, L.L.C.

DIMENSIONS

Steel Hook-Up Accessory Series

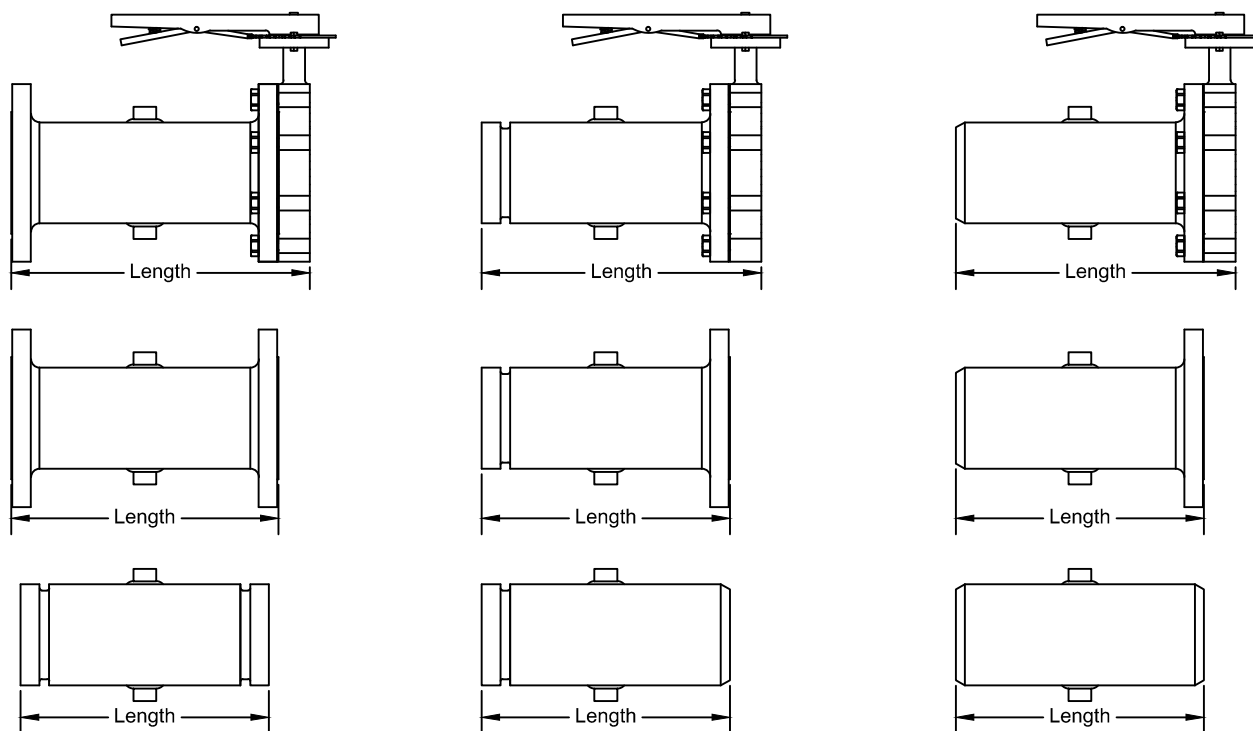

Model	End Connections	2-1/2"		3"		4"		6"	
		Length	Weight	Length	Weight	Length	Weight	Length	Weight
AWB	Weld x Butterfly Valve	10.8	22	11.0	25	11.6	38	12.4	63
AGB	Groove x Butterfly Valve	10.8	21	11.0	26	11.6	38	12.4	68
AFB	Flange x Butterfly Valve	13.6	30	13.8	34	14.7	52	16.0	97
AFF	Flange x Flange	11.8	19	12.0	22	12.7	35	13.8	67
AFG	Flange x Groove	9.0	12	9.2	14	9.6	21	10.2	38
AFW	Flange x Weld	9.0	11	9.2	13	9.6	21	10.2	33
AGG	Groove x Groove	9.0	5	9.2	7	9.6	9	10.2	16
AGW	Groove x Weld	9.0	5	9.2	7	9.6	9	10.2	16
AWW	Weld x Weld	9.0	4	9.2	6	9.6	8	10.2	15

Note: All dimensions, weights, and materials are subject to minor variations. Consult with factory for confirmation of dimensions, weights, and material specifications at the time of order. Custom lengths are available upon request for an additional charge.

BUTTERFLY VALVE END CONNECTION OPTIONS

Slip-On Flange				
Size	Model	Length	Weight	
2-1/2"	FL250SO	+ 1.1	+ 7	
3"	FL300SO	+ 1.2	+ 8	
4"	FL400SO	+ 1.3	+ 13	
6"	FL600SO	+ 1.6	+ 19	

Weld Neck Flange				
Size	Model	Length	Weight	
2-1/2"	FL250WN	+ 2.8	+ 11	
3"	FL300WN	+ 2.8	+ 14	
4"	FL400WN	+ 3.0	+ 16	
6"	FL600WN	+ 3.5	+ 25	

Flange Grooved Adapter				
Size	Model	Length	Weight	
2-1/2"	FGA250	+ 4.8	+ 13	
3"	FGA300	+ 4.8	+ 16	
4"	FGA400	+ 5.0	+ 18	
6"	FGA600	+ 5.5	+ 28	